

**FACILITIES BEING ESTABLISHED**

- CT SCAN (Trauma Center)
- UPGRADATION OF EMERGENCY
- ICU
- CCU
- DIALYSIS
- PHYSIOTHERAPY
- BURN UNIT
- DENTAL UNIT
- LAUNDRY
- MORTUARY
- YELLOW ROOM
- WATER FILTRATION PLANT
- CANTEEN

**SERVICES TO BE OUTSOURCE**

- MEP
- JANITORIAL
- PARKING & SECURITY
- CAFETERIA
- AC's & GENERATORS
- LAUNDRY
- CT SCAN
- PATHOLOGY LABS
- HORTICULTURE

**THEMATIC AREAS OF MSDS**

- 2.1 ACCESS, ASSESSMENT, AND C. CONTINUITY OF CARE (AAC)
- CARE OF PATIENTS (COP)
- MANAGEMENT OF MEDICATION (MOM)
- PATIENT RIGHTS AND EDUCATION (PRE)
- HOSPITAL INFECTION CONTROL (HIC)
- CONTINUOUS QUALITY IMPROVEMENT (CQI)
- RESPONSIBILITIES OF MANAGEMENT (ROM)
- FACILITY MANAGEMENT AND SAFETY (FMS)
- HUMAN RESOURCE MANAGEMENT (HRM)
- INFORMATION MANAGEMENT SYSTEM (IMS)

**IT INTERVENTIONS**

- QUEUE MANAGEMENT SYSTEM
- ELECTRONIC MEDICAL RECORD

**NEW MANAGEMENT STRUCTURE**

- NMS
- CONSULTANTS
- NURSES
- WMO's
- EMO's
- AHP
- PHARMACISTS
- PHYSIOTHERAPISTS

BY:  
PROJECT MANAGEMENT UNIT  
PRIMARY & SECONDARY  
HEALTHCARE DEPARTMENT  
GOVT. OF PUNJAB

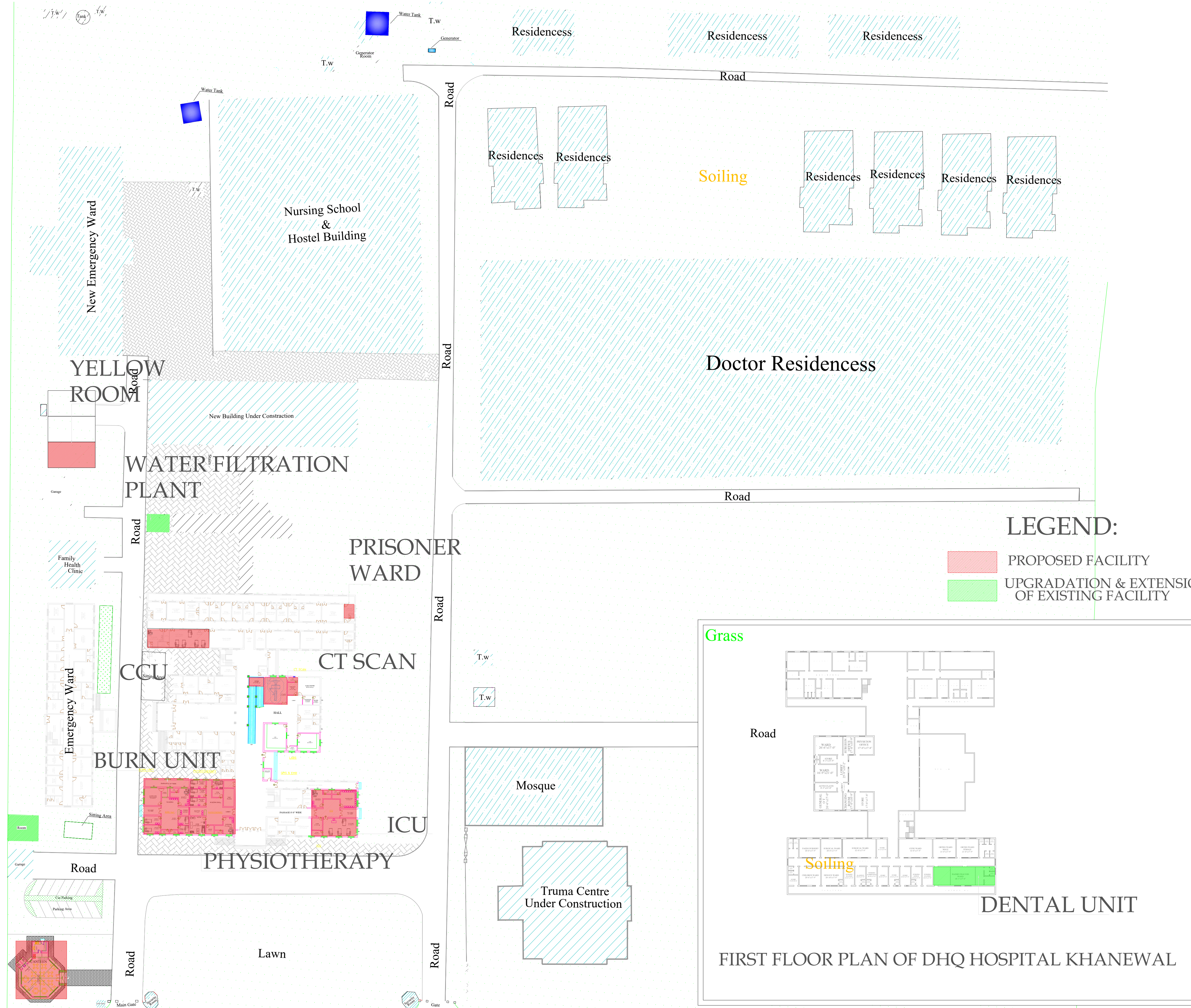

**LEGEND:**

- PROPOSED FACILITY
- UPGRADATION & EXTENSION OF EXISTING FACILITY

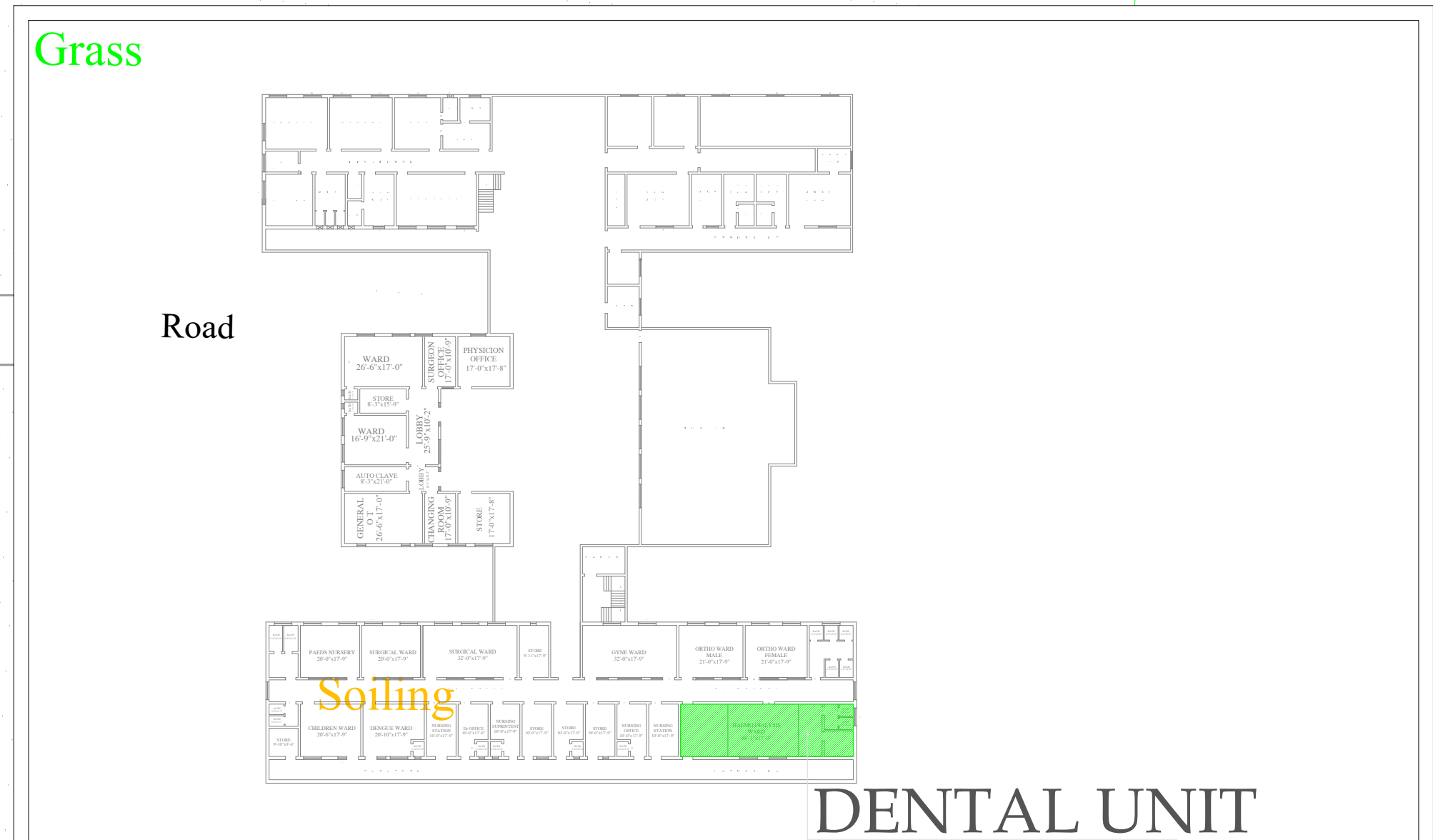

FIRST FLOOR PLAN OF DHQ HOSPITAL KHANEWAL

**MACHINERY & EQUIPMENTS**

Emergency Equipment	Area	ITEM DESCRIPTION
Reception Area	Table	Chairs
	Computer Data Entry With Printer	Printer
	Table (2 x 6) (20)	Chairs (20)
Triage area	10 x 6 apparatus with 1000/200	Gurnies WITH FOOT STEPPING
	Mercury 8 P apparatus (20)	Laryngoscope packs adult & paediatric
	Diagnosis set (20)	ECG Machine with 1000/200
	Center oxygen with accessories	FOR each
	NEBUZET (20)	SUCKER MACHINE (20)
	CRASH TROLLY EQUIP (20)	INSTRUMENT CABINET (20)
	MEDICINE TROLLY (20)	O 2 tank WITH hose
	Center Oxygen supply	Sucker machine
	Portable O 2 Units	Ceiling O 2 Lights
	Hot air oven	Autoclave
Minor O.T	Instrument trolley (20)	Instrument cabinet
	SUCKER MACHINE (20)	Sucker machine (20)
	Resuscitator (20)	Center Oxygen supply (20)
	Resuscitation Trolley (40)	Resuscitation Trolley (40)
	Defibrillator (20)	Defibrillator (20)
	Bedside monitor (20)	Bedside monitor (20)
	ECG MACHINE (20)	ECG MACHINE (20)
	BP APPARATUS (20)	BP APPARATUS (20)
	ATTENDANT BENCH (20)	ATTENDANT BENCH (20)
	(MOTORIZED BEDS) with accessories with foot step (20)	ECG machine with 1000/200 (20)
Emergency ward	ECG machine with 1000/200	Bedside monitor (20)
	Resuscitator (20)	Resuscitator (20)
	Sucker machine (20)	Sucker machine (20)
	Ward chair (20)	Ward chair (20)
	Stretcher (20)	Stretcher (20)
	ambulance gurnies with Mask (20)	ambulance gurnies with Mask (20)
	ambulance gurnies with Mask (20)	ambulance gurnies with Mask (20)
	Portable x-rays (200 M.A)	Portable x-rays (200 M.A)
	Portable ultrasound	Portable ultrasound
	Shoe Cover Machine	Vein Finder
Acoustic Ceiling Board		
Others	Acoustic Ceiling Board	
<b>Medical Equipment</b>		
Laboratory	Semi Auto Clinical Chemistry Analyzer	Hematology Analyzer
	Electrode Analyzer	Blood Gas Analyzer
	Clinical Microscope	Water bath
	Hot air Oven	Cooled water plant
	Auto pipettes	glass vials
	Centrifuge Machine	Blank X-ray Machine
	Mobile X-ray Machine	Computed Radiography System
	Center X-ray	Center X-ray
	Lead apron and F.P.E	Lead apron and F.P.E
	Dental mobile apparatus (A&S)	Lead glass shield
X-Rays	Lead shield	Portable/Mobile Ultrasound
	Color Doppler RADIOLOGY	Color Doppler RADIOLOGY
	Cardiac Monitor	Temporary pacemaker
	Defibrillator	Defibrillator
	ECG Machine Three Channel	ECG Machine Three Channel
	ECG Machine RADIOLOGY	ECG Machine RADIOLOGY
	Suction Pump	Blood Collector
	Centrifuge Machine	Slide viewer
	Clinical Microscope	Computerized Hemo Diapase Machine
	Baby cot	Phototherapy Unit
Blood Bank	Phototherapy Unit	Heart Warmer
	Heart Warmer	Heart Incubator
	Heart Incubator	Infant Gracle Nebulizer Heavy Duty
	Infant Gracle Nebulizer Heavy Duty	Anesthesia Machine with Ventilator
	Anesthesia Machine with Ventilator	BED SIDE PATIENT MONITOR
	BED SIDE PATIENT MONITOR	ECG Monitor
	ECG Monitor	Defibrillator
	Defibrillator	Defibrillator
	Defibrillator	Electrocardiogram Unit
	Electrocardiogram Unit	Operation Table
O.T (84)	Operation Table	Ceiling Operating Light
	Ceiling Operating Light	STEAM STERILIZER
	STEAM STERILIZER	Resuscitation trolley With Crash Cart
	Resuscitation trolley With Crash Cart	imaging table
	imaging table	MOBILE OPERATING LIGHT
	MOBILE OPERATING LIGHT	Operation Table
	Operation Table	ORTHOPEDIC DRILL
	ORTHOPEDIC DRILL	Fluoride Ceiling Fluoroscope
	Fluoride Ceiling Fluoroscope	Pneumatic Tomographs
	Pneumatic Tomographs	Orthopedic Instruments
Orthopedic	Orthopedic Instruments	Portable/Mobile Ultrasound
	Portable/Mobile Ultrasound	Autoclave
	Autoclave	Delivery Set
	Delivery Set	Washing Table
	Washing Table	ECG Monitor
	ECG Monitor	D & S Set
	D & S Set	Vacuum Collector
	Vacuum Collector	CTG Machine
	CTG Machine	ECG Machine Three Channel
	ECG Machine Three Channel	Delivery table
Gynaecology (20 beds)	Delivery table	Baby Cot
	Baby Cot	Delivery table
	Delivery table	Desktop Fetal Heart Rate Detector
	Desktop Fetal Heart Rate Detector	Steam Sterilizer
	Steam Sterilizer	Operation Table
	Operation Table	MOBILE OPERATING LIGHT
	MOBILE OPERATING LIGHT	Suction Pump
	Suction Pump	Laryngoscope
	Laryngoscope	Set of Surgical Instruments
	Set of Surgical Instruments	Shedder
Surgical Emergency (10 beds)	Shedder	Shedder
	Shedder	Shedder
	Shedder	Shedder
	Shedder	Shedder
	Shedder	Shedder
	Shedder	Shedder
	Shedder	Shedder
	Shedder	Shedder
	Shedder	Shedder
	Shedder	Shedder
Others	Shedder	Shedder
	Shedder	Shedder
	Shedder	Shedder
	Shedder	Shedder
	Shedder	Shedder
	Shedder	Shedder
	Shedder	Shedder
	Shedder	Shedder
	Shedder	Shedder
	Shedder	Shedder
<b>Machinery and Equipment (General)</b>		
Machinery and Equipment (General)	Refrigerator (Domestic) front glass double door	Refrigerator (Domestic) front glass double door
	Refrigerator glass single door	Refrigerator glass single door
	Air Curtain On Door	Washing machines for parties
	Washing machines for parties	Gas burner for parties
	Gas burner for parties	Fire extinguishers (20)
	Fire extinguishers (20)	LED TV
	LED TV	4 Ton air conditioners (Cabinet)
	4 Ton air conditioners (Cabinet)	2 Ton air conditioners (Cabinet)
	2 Ton air conditioners (Cabinet)	Ceiling Fans 10"
	Ceiling Fans 10"	Blacked Fans 16"
Blacked Fans 16"	Industrial Exhaust	
Industrial Exhaust	Refrigerators 10 CFT	
Refrigerators 10 CFT	Over Connection of Electricity / Express Line etc.	
Over Connection of Electricity / Express Line etc.	Electrical Distribution Boxes	
Electrical Distribution Boxes	Protection cabin for electricity distribution boxes	
Protection cabin for electricity distribution boxes	Bed Sheets and pillow covers	
Bed Sheets and pillow covers	Blankets	
Blankets	Blankets with covers	
Blankets with covers	CCTV Camera	
CCTV Camera	CCTV Camera top dome	
CCTV Camera top dome	Fire extinguishers	
Fire extinguishers	DVR	

MASTER PLAN OF DHQ HOSPITAL KHANEWAL