

### FACILITIES BEING ESTABLISHED

- CT SCAN (Trauma Center)
- UPGRADATION OF EMERGENCY
- ICU
- CCU
- DIALYSIS
- PHYSIOTHERAPY
- BURN UNIT
- DENTAL UNIT
- LAUNDRY
- MORTUARY
- YELLOW ROOM
- WATER FILTRATION PLANT
- CANTEEN

### SERVICES TO BE OUTSOURCE

- MEP
- JANITORIAL
- PARKING & SECURITY
- CAFETERIA
- AC's & GENERATORS
- LAUNDRY
- CT SCAN
- PATHOLOGY LABS
- HORTICULTURE

### THEMATIC AREAS OF MSDS

- 2.1 ACCESS, ASSESSMENT, AND C.O.N.T.I.N.U.I.T.Y OF CARE (AAC)
- CARE OF PATIENTS (COP)
- MANAGEMENT OF MEDICATION (MOM)
- PATIENT RIGHTS AND EDUCATION (PRE)
- HOSPITAL INFECTION CONTROL (HIC)
- CONTINUOUS QUALITY IMPROVEMENT (CQI)
- RESPONSIBILITIES OF MANAGEMENT (ROM)
- FACILITY MANAGEMENT AND SAFETY (FMS)
- HUMAN RESOURCE MANAGEMENT (HRM)
- INFORMATION MANAGEMENT SYSTEM (IMS)

### IT INTERVENTIONS

- QUEUE MANAGEMENT SYSTEM
- ELECTRONIC MEDICAL RECORD

### NEW MANAGEMENT STRUCTURE

- NMS
- CONSULTANTS
- NURSES
- WMO's
- EMO's
- AHP
- PHARMACISTS
- PHYSIOTHERAPISTS

BY:  
PROJECT MANAGEMENT UNIT  
PRIMARY & SECONDARY  
HEALTHCARE DEPARTMENT  
GOVT. OF PUNJAB

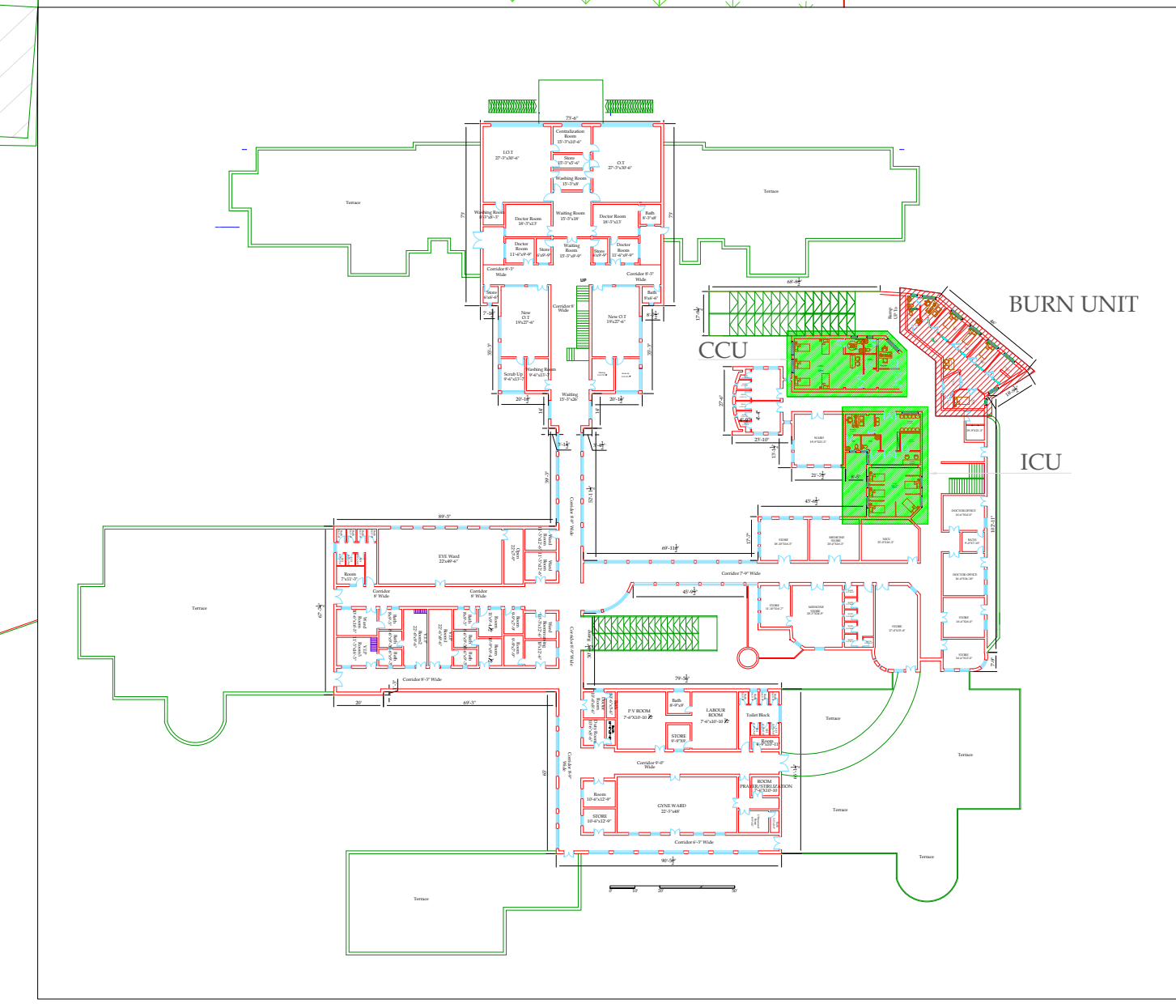

# MASTER PLAN OF DHQ HOSPITAL ATTOCK

### MACHINERY & EQUIPMENTS

| Area                              | ITEM DESCRIPTION  |
|-----------------------------------|---|
| Emergency Equipment               | Table<br>Chairs<br>Computer Data Entry With Printer   |
| Reception Area                    | Table<br>Chairs (2)   |
| Trage area                        | EGG Machine with trolley (2)<br>Center oxygen with accessories<br>EGG each<br>NEULIGHT HEAT<br>SUCKER MACHINE (2)<br>CRASH TROLLEY EQUIP (2)<br>INSTRUMENT CABINET (2)<br>MEDICINE TROLLEY (2)<br>O 2 tank with hose<br>Center Oxygen supply<br>Sucker machine<br>Portable O 2 Lights   |
| Minor O.T                         | Ceiling light<br>Hot air oven<br>Autoclave<br>Instrument trolley (2)<br>Instrument cabinet<br>SUCKER (2)<br>Sucker machine (2)<br>Neulight HD (2)<br>Center Oxygen supply (2)<br>Resuscitation Trolley (2)  |
| Constant / specialized care room  | Defibrillator (2)<br>Pulse oximeter (2)<br>Bedside monitor (2)<br>EGG MACHINE (2)<br>BP APPARATUS (2)<br>ECG STRIP (2)<br>ATTENDANT BENCH (2)<br>(MOTORIZED BEDS) with accessories with foot step (2)<br>EGG machine with trolley (2)<br>Pulse oximeter (2)<br>Bedside monitor (2)<br>EGG Machine with trolley (2)<br>Neulight HD (2)<br>Sucker machine (2)   |
| Emergency ward                    | Ward chair (2)<br>Shelver (2)<br>ambulance gurney with Mask (2)<br>ambulance gurney with Mask (2)<br>Jallart bed (2)<br>Portable X-ray (200 M.A)<br>Portable ultrasound<br>Shoe Cover Machine<br>Ven Printer<br>Acetic Cleaning Board   |
| Generated                         | Portable ultrasound<br>Shoe Cover Machine<br>Ven Printer<br>Acetic Cleaning Board   |
| Others                            |   |
| <b>Medical Equipment</b>          |   |
| Area                              | Name of Equipment   |
| Laboratory                        | Semi Auto Clinical Chemistry Analyzer   |
|                                   | Hematology Analyzer   |
|                                   | Electrode Analyzer  |
|                                   | Blood Gas Analyzer  |
|                                   | Clinical Microscope   |
|                                   | Water Bath  |
| X.Rays                            | Hot air Oven  |
|                                   | Chester water plant   |
|                                   | Auto pipettes   |
|                                   | glass vials   |
|                                   | Centrifuge Machine  |
|                                   | Static X-ray Machine  |
| Ultrasound                        | Mobile X-Ray Machine  |
|                                   | Computerized Radiography System   |
|                                   | Center X-Ray  |
|                                   | Lead apron and F.P.E.   |
|                                   | Gamma camera (Acid)   |
|                                   | Lead glass shield   |
| OCU                               | Leid shield   |
|                                   | Portable/Mobile Ultrasound  |
|                                   | Color Doppler RADIOLOGY   |
|                                   | Color Doppler   |
|                                   | Temporary plate maker   |
|                                   | Defibrillator   |
| Blood Bank                        | ECG Machine Three Channel   |
|                                   | ETT Machine   |
|                                   | Color Doppler RADIOLOGY   |
|                                   | Suction Pump  |
|                                   | Blood Collector   |
|                                   | Centrifuge Machine  |
| Dialysis Unit (10 beds)           | Slide cover   |
|                                   | Clinical Microscope   |
|                                   | Computerized Nemo Dialysis Machine  |
|                                   | Baby cot  |
|                                   | Phototherapy Unit   |
|                                   | Hand Warmer   |
| Nursery                           | Pulse Oximeter  |
|                                   | Heart Incubator   |
|                                   | Neonatal Grate Nebulizer Heavy Duty   |
|                                   | Anesthesia Machine with Ventilator  |
|                                   | BED SIDE PATIENT MONITOR  |
|                                   | ECG Monitor   |
| O.T (24)                          | Defibrillator   |
|                                   | Electrocauter Unit  |
|                                   | Operation Table   |
|                                   | Ceiling Operating Light   |
|                                   | STEAM STERILIZER  |
|                                   | Resuscitation trolley With Crash Cart   |
| Orthopedic                        | imago table   |
|                                   | MOBILE OPERATING LIGHT  |
|                                   | Operation Table   |
|                                   | OSTHOPEDIC DRILL  |
|                                   | Plaster Ceiling Drains  |
|                                   | Pneumatic Tomopasts   |
| Gynaec (20 beds)                  | Orthopedic Instruments  |
|                                   | Portable/Mobile Ultrasound  |
|                                   | Autoclave   |
|                                   | Delivery Set  |
|                                   | Delivery Table  |
|                                   | ECG Monitor   |
| Surgical Emergency (10 beds)      | D & S Set   |
|                                   | Vacuum Extractor  |
|                                   | C.T.O Machine   |
|                                   | ECG Machine Three Channel   |
|                                   | Delivery table  |
|                                   | Baby Cot  |
| Others                            | Delivery table  |
|                                   | Desktop Fetal Heart Rate Detector   |
|                                   | Strain Sterilizer   |
|                                   | Operation Table   |
|                                   | MOBILE OPERATING LIGHT  |
|                                   | Suction Pump  |
| Machinery and Equipment (General) | Latrigo scope   |
|                                   | Set of Surgical Instruments   |
| Others                            | Shelver<br>Insect chair<br>foot support<br>Resuscitation trolley With Crash Cart<br>Resuscitation trolley With Crash Cart<br>BP Apparatus<br>Ventilator<br>CPAP<br>X-RAY PROCESSOR<br>Blank wall Stand (2x4x8) top<br>Imago Intraoral<br>Central Medical Gase Pipe Line System<br>Refrigerator glass single Door<br>Dishwasher Machine<br>CCTV Camera top dome<br>Washing Machines<br>CCTV Camera<br>Shelver<br>DVR for CCTV Camera<br>Sound System for announcements<br>Fire extinguishers<br>LED TV |