

FACILITIES BEING ESTABLISHED

- CT SCAN (Trauma Center)
- UPGRADATION OF EMERGENCY
- ICU
- CCU
- DIALYSIS
- PHYSIOTHERAPY
- BURN UNIT
- DENTAL UNIT
- LAUNDRY
- MORTUARY
- YELLOW ROOM
- WATER FILTRATION PLANT
- CANTEN

SERVICES TO BE OUTSOURCE

- MEP
- JANITORIAL
- PARKING & SECURITY
- CAFETERIA
- AC's & GENERATORS
- LAUNDRY
- CT SCAN
- PATHOLOGY LABS
- HORTICULTURE

THEMATIC AREAS OF MSDS

- 2.1 ACCESS, ASSESSMENT, AND C.O.N.T.I.N.U.I.T.Y OF CARE (AAC)
- CARE OF PATIENTS (COP)
- MANAGEMENT OF MEDICATION (MOM)
- PATIENT RIGHTS AND EDUCATION (PRE)
- HOSPITAL INFECTION CONTROL (HIC)
- CONTINUOUS QUALITY IMPROVEMENT (CQI)
- RESPONSIBILITIES OF MANGEMENT (ROM)
- FACILITY MANAGEMENT AND SAFETY (FMS)
- HUMAN RESOURCE MANGEMENT (HRM)
- INFORMATION MANGEMENT SYSTEM (IMS)

IT INTERVENTIONS

- QUEUE MANAGEMENT SYSTEM
- ELECTRONIC MEDICAL RECORD

NEW MANAGEMENT STRUCTURE

- NMS
- CONSULTANTS
- NURSES
- WMO's
- EMO's
- AHP
- PHARMACISTS
- PHYSIOTHERAPISTS



BY:
PROJECT MANAGEMENT UNIT
PRIMARY & SECONDARY
HEALTHCARE DEPARTMENT
GOVT. OF PUNJAB

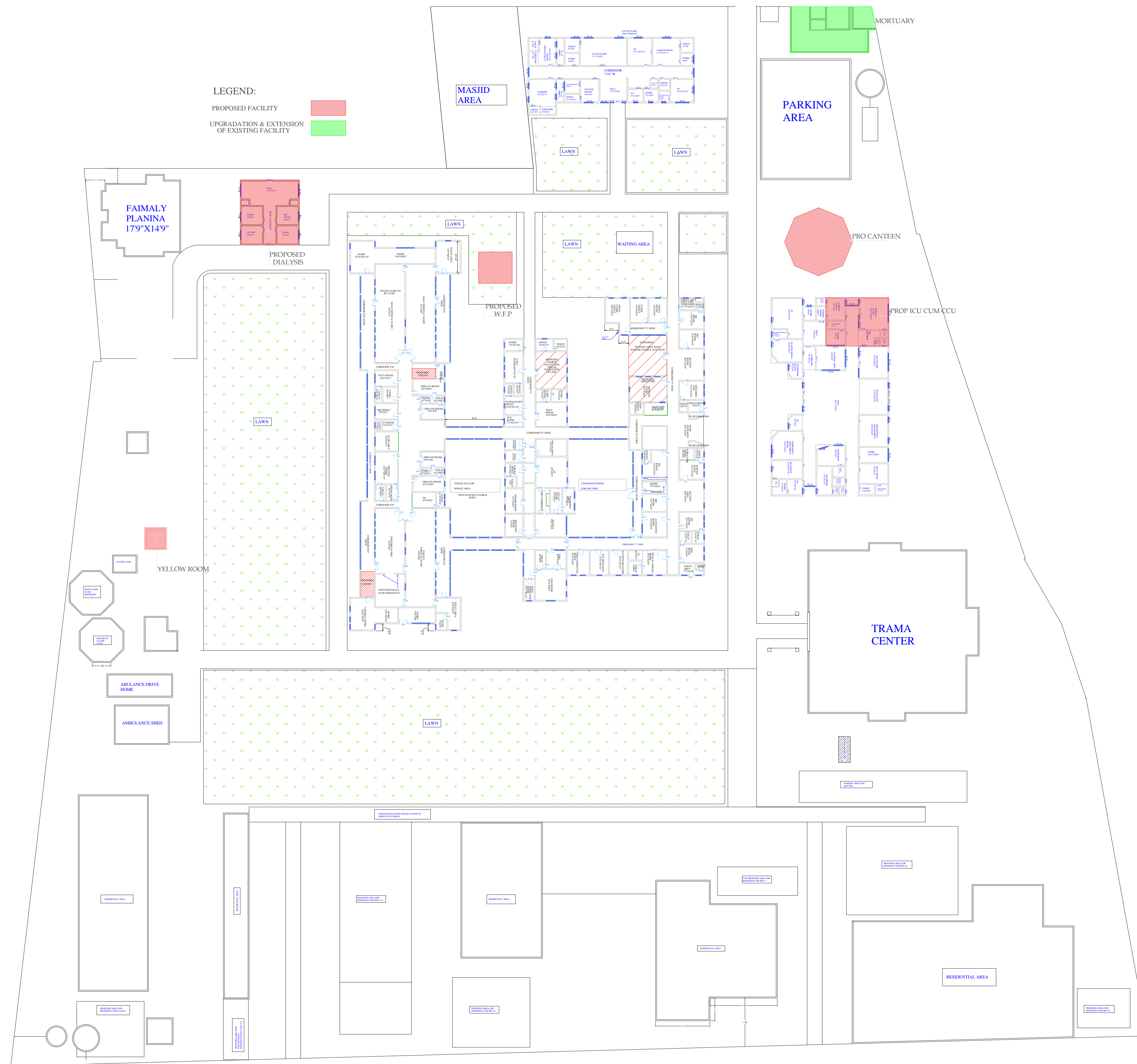

MASTER PLAN OF THQ HOSPITAL TAUNSA

MACHINERY & EQUIPMENTS

Emergency Equipment		
Area	Name of Equipment	
Reception Area	Table 2' x 4' 6" (2)	
Triage area	Chair	
	Computer Gate Entry With Printer	
	Chair - 10	
	First Aid kit (10)	
	Gumby (with 100) (5)	
	Mirror 8" diameter (10)	
	Laryngoscope pieces & size 4	
	Diagnostic set (10)	
	ECG Machine (with table) (10)	
	Central Oxygen with accessories	
Minor O.T.	FOR each	
	NEBULIZER (10)	
	SUCKER MACHINE (10)	
	CRASH TROLLY EQUIPPED (10)	
	RESTRAINT CABINET (10)	
	MEDICINE TROLLY (10)	
	O.T table WITH hot stop	
	Center Oxygen supply	
	Sucker machine	
	Portable O.L. Light	
Constant specialized care room	Hot air oven	
	Autoclave	
	Isolation table (10)	
	Resturant cabinet	
	SURINE (10)	
	Sucker machine (10)	
	Refrigerator (10)	
	Center Oxygen supply (10)	
	Resuscitation trolley (fully equipped) (10)	
	Defibrillator	
Emergency ward	Public comment (10)	
	Bedside monitor (10)	
	ECG MACHINE (10)	
	BP APPARATUS (10)	
	FOOT STEPIER (10)	
	ATTENDANT BENCH (10)	
	MOTORISED BEDS with accessories (with hot stop) (10)	
	ECG machine trolley (10)	
	Public comment (10)	
	Bedside monitor (10)	
Generalized	B.P. apparatus wall type (10)	
	Neulizer 10 (10)	
	Sucker machine (10)	
	Wheat chiller (10)	
	Sterilizer (10)	
	Infusion pumps with Mass (10)	
	Amnio bag with Mass (10)	
	Infusion pump (10)	
	Portable X-rays (200 M.A.)	
	Proctore ultra sound	
Medical Equipment	Shoe Cover Machine	
	Yan Finder	
	Azox Crayle Board	
	Area	Name of Equipment
	Laboratory	Semi Auto Clinical Chemistry Analyser
		Hematology Analyser
		Electrolyte Analyser
		Blood Gas Analyser
		Clinical Microscope
		Water Bath
Hot air Oven		
Dustless water plant		
Auto processor		
glass ware		
X-Rays	Static X-ray Machine	
	Moblie X-ray Machine	
	Computerized Radiography System	
	Diap 2.0	
	Lead apron and PPE	
	Dermis monitor personal (A&S)	
	Lead glass shield	
	Lead Wall	
	Portable/ Mobile Ultrasound	
	Ultrasound	Color Doppler RADULOGY
Cardiac Monitor		
Temporary pace maker		
Defibrillator		
ECG Machine Three Channel		
EIT Machine		
Color Dopler CARDULOGY		
Suction Pump		
Blood Cabinet		
Blood Bank		Central Gas Machine
	Slide viewer	
	Clinical Microscope	
	Computerized Hemo Dialysis	
	Monitor	
	Baby Cot	
	Phototherapy Unit	
	Pulse Oximeter	
	Heart Monitor	
	Nursery	Hospital Grade Nebulizer Healy D&V
Anesthesia Machine with Ventilator		
BED SIDE PATENT MONITOR		
ECU Monitor		
Defibrillator		
Defibrillator		
Electrocardiogram Unit		
Operation Table		
Central Operating Light		
STAND STILL LIGHT		
O.T (04)	Resuscitation trolley With Crash Cart	
	crayle table	
	MOBILE OPERATING LIGHT	
	Operation Table	
	ORTHOPEDIC DRILL	
	Phase Cutting Pneumatic	
	Pneumatic Torquants	
	Orthopedic Instruments	
	Portable/ Mobile Ultrasound	
	Orthopedic	Autoclave
Delivery Set		
Delivery Table		
ECU Monitor		
D.R.C. Set		
Vacuum Extractor		
ECG Machine Three Channel		
Infusion pump Light		
Baby Cot		
Delivery table		
Surgical Emergency (10 beds)	Desator Fetal Heart Rate Detector	
	Swarm Sterilizer	
	Operation Table	
	MOBILE OPERATING LIGHT	
	Suction Pump	
	Laryngoscope	
	Set of Surgical Instruments	
	Stretcher	
	wheel chair	
	foot support	
Others	Resuscitation trolley With Crash Cart	
	Resuscitation trolley With Crash Cart	
	BP Apparatus	
	Ventilator	
	CRASH	
	X-RAY PROCESSOR	
	Hand wash Soap Dispense By	
	Issue Receiver	
	Central Medical Gess Pipe Line System	
	Refrigerator glass single door	
Machinery and Equipment (General)	Diathermy Machine	
	CC TV Camera top dome	
	Videoing Machine	
	CC TV Camera	
	Shower	
	DVR for CCTV Camera	
	Sound System for announcements	
	Fire Extinguishers	
	LED TV	
	Refrigerator (Domestic) Front glass double door	
Refrigerator glass single door		
Air Curtain On Door		
Washing machine for patients		
Gas Burner for patients		
First Aid kit (10)		
LED TV		
4 Ton air conditioners (Cabinet)		
2 Ton air conditioners (Cabinet)		
4 Ton air conditioners (split)		
Ceiling fans 50"		
Washing fan 10"		
Industrial Exhaust		
Refrigerator 10 CF FT		
Dual Connection of Electricity /		
Electric Line		
Electric Distribution Boxes		
Protection cabin for electricity distribution boxes		
Bed Sheets and pillow covers		
Pillows		
Blankets with covers		