

### FACILITIES BEING ESTABLISHED

- CT SCAN
- UPGRADATION OF EMERGENCY
- ICU
- CCU
- DIALYSIS
- PHYSIOTHERAPY
- BURN UNIT
- DENTAL UNIT
- LAUNDRY
- MORTUARY
- YELLOW ROOM
- WATER FILTRATION PLANT
- CANTEEN

### SERVICES TO BE OUTSOURCE

- MEP
- JANITORIAL
- PARKING & SECURITY
- CAFETERIA
- AC's & GENERATORS
- LAUNDRY
- CT SCAN
- PATHOLOGY LABS
- HORTICULTURE

### THEMATIC AREAS OF MSDS

- 2.1 ACCESS, ASSESSMENT, AND C.ONTINUITY OF CARE (AAC)
- CARE OF PATIENTS (COP)
- MANAGEMENT OF MEDICATION (MOM)
- PATIENT RIGHTS AND EDUCATION (PRE)
- HOSPITAL INFECTION CONTROL (HIC)
- CONTINUOUS QUALITY IMPROVEMENT (CQI)
- RESPONSIBILITIES OF MANAGEMENT (ROM)
- FACILITY MANAGEMENT AND SAFETY (FMS)
- HUMAN RESOURCE MANAGEMENT (HRM)
- INFORMATION MANAGEMENT SYSTEM (IMS)

### IT INTERVENTIONS

- QUEUE MANAGEMENT SYSTEM
- ELECTRONIC MEDICAL RECORD

### NEW MANAGEMENT STRUCTURE

- NMS
- CONSULTANTS
- NURSES
- WMO's
- EMO's
- AHP
- PHARMACISTS
- PHYSIOTHERAPISTS



BY:  
PROJECT MANAGEMENT UNIT  
PRIMARY & SECONDARY  
HEALTHCARE DEPARTMENT  
GOVT. OF PUNJAB

### LEGEND:

PROPOSED FACILITY

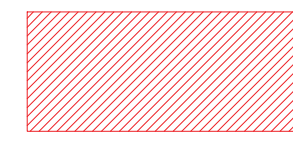

UPGRADATION & EXTENSION OF EXISTING FACILITY

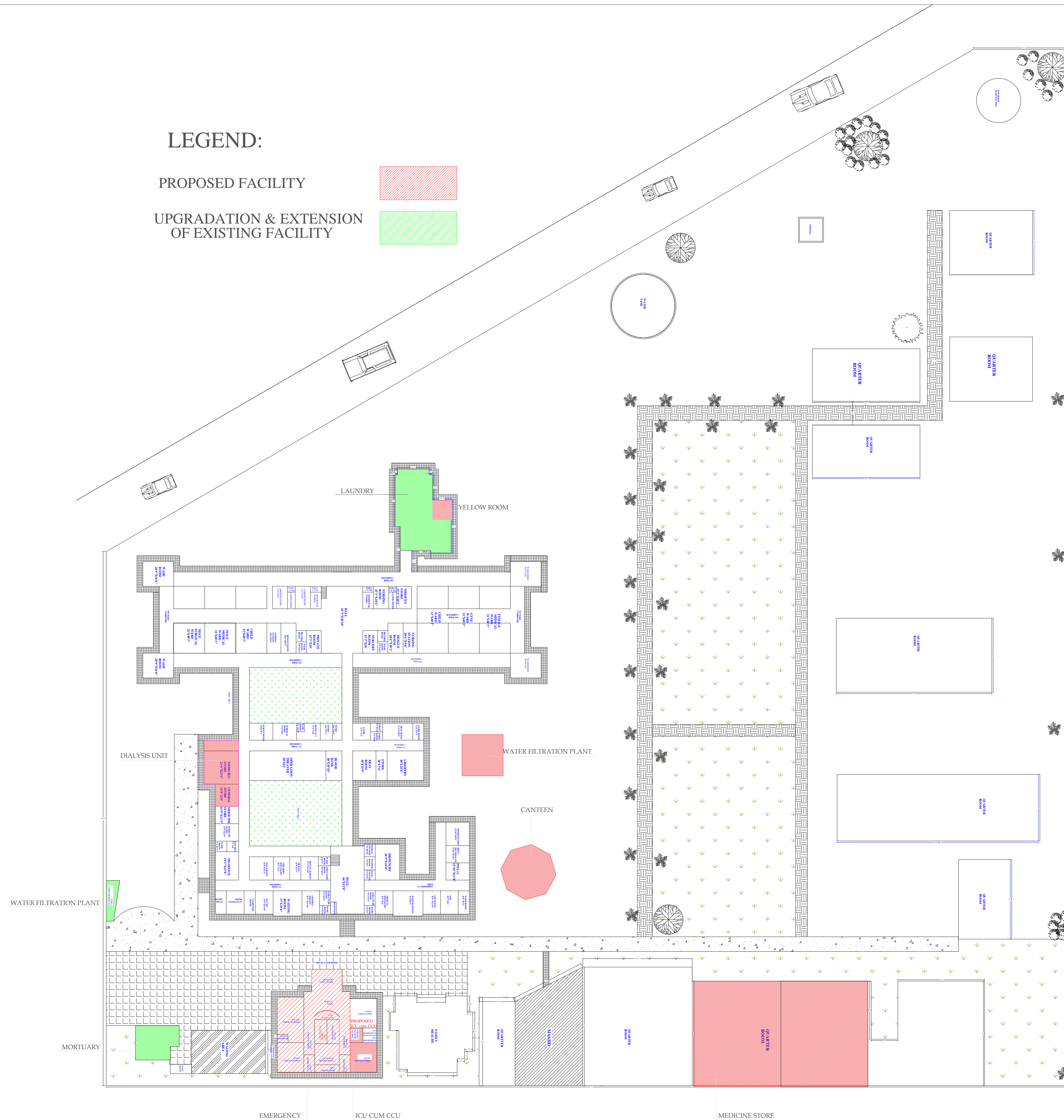
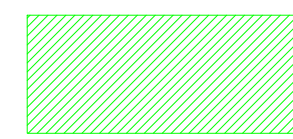

### MACHINERY & EQUIPMENTS

Area	ITEM DESCRIPTION	
Reception Area	Table	
	Chair	
	Computer Data Entry With Printer	
	Table 22 X 42" IN	
	Chair 7" IN	
	8 x 8 apron/well top 7" IN	
	Gurney WITH FOOT & STEP 7" IN	
	Security B.P apparatus 7" IN	
	Laryngoscope pads 4x4x4 7" IN	
	Diagnostic set 7" IN	
Triage area	ECG Machine with table 7" IN	
	Central oxygen with accessories 7" IN	
	NEBULIZER 7" IN	
	SUCKER MACHINE 7" IN	
	CRASH TROLLY EQUIPPED 7" IN	
	INSTRUMENT CABINET 7" IN	
	MEDICAL TROLLY 7" IN	
	O.T table WITH foot step	
	Center Oxygen supply	
	Sucker machine	
Minor O.T	Portable O.T Lights	
	Calving light	
	Hot air oven	
	Autoclave	
	Instrument trolley 7" IN	
	INSTRUMENT CABINET 7" IN	
	GURNEY 7" IN	
	Sucker machine 7" IN	
	Nebulizer 4" IN	
	Center Oxygen supply 7" IN	
Constant / specialized care room	Resuscitation Trolley 7" IN	
	Emergency 7" IN	
	Catheterizer 7" IN	
	ECG MACHINE 7" IN	
	BP APPARATUS 7" IN	
	FOOT STEP 7" IN	
	ATTENDANT BENCH 7" IN	
	MOTORIZED BEDS with accessories (with foot step) 7" IN	
	ECG machine with table 7" IN	
	Pulse oximeter 7" IN	
Emergency ward	Resuscitation trolley	
	B.P apparatus well top 7" IN	
	Nebulizer 4" IN	
	Sucker machine 7" IN	
	Wheel chair 7" IN	
	Stretcher 7" IN	
	ambu bag pads with Mask 7" IN	
	ambu bag adult with Mask 7" IN	
	Portable x-ray 300 M.A.	
	Portable ultra sound	
Generalized	Shoe Care Machine	
	Ven Finder	
	Acrylic Display Board	
	<b>Medical Equipment</b>	
	Laboratory	Sem Auto Clinical Chemistry Analyzer
		Hematology Analyzer
		Electrolyte Analyzer
		Blood Gas Analyzer
		Clinical Microscope
		Wash bath
Hot air Oven		
Colded water plant		
Autoclaves		
glass器皿		
X-Rays	Static X-ray Machine	
	Mobile X-ray Machine	
	Computerized Radiography System	
	Dark x-ray	
	Lead apron and PPE	
	Genital radioprotect (GDR)	
	Lead glass shield	
	Lead film	
	Portable/Mobile Ultrasound	
	Color Doppler RADIOLOGY	
Ultrasound	Color Doppler RADIOLOGY	
	Cardiac Monitor	
	Temporary pace maker	
	ECG Machine Three Channel	
	E.T Machine	
	Color Doppler CARDIOLOGY	
	Stethoscope	
	Blood Cabinet	
	Centrifuge Machine	
	Slide viewer	
CCU	Clinical Microscope	
	Computerized Hematology Analyzer	
	Machine	
	Baby Cot	
	Prosthesia Unit	
	Heart Warmer	
	Pulse Oximeter	
	Heart Incubator	
	Respirator	
	Resuscitation Heavy Duty	
Nursery	Anesthesia Machine with Ventilator	
	RESERVE PATIENT MONITOR	
	CU Monitor	
	Defibrillator	
	Defibrillator	
	Electrosurgical Unit	
	Operation table	
	Central Operating Light	
	STETHEOSCOPES	
	Resuscitation trolley With Crash Cart	
mayo table		
MONITORING TROLLEY		
O.T (04)	Operation table	
	ORTHOPEDIC DRESSING	
	Pneumatic	
	Pneumatic Torque	
	Orthopedic Instruments	
	Portable/Mobile Ultrasound	
	Sublight	
	Delivery Set	
	Emergency table	
	CU Monitor	
Gynae (20 beds)	D & C Set	
	Vacuum Extractor	
	C.T.G Machine	
	ECG Machine Three Channel	
	delivery table Lights	
	Baby Cot	
	Delivery Trolley	
	Central Heart Rate Detector	
	Steam Sterilizer	
	Operation table	
MOBILE OPERATING LIGHT		
Surgical Emergency (10 beds)	Suction Pump	
	Laryngoscope	
	Set of Surgical Instruments	
	Stretcher	
	wheel chair	
	foot support	
	Resuscitation trolley With Crash Cart	
	Resuscitation trolley With Crash Cart	
	BP Apparatus	
	Ventilator	
CRASH		
X-RAY PROCESSOR		
Hand wash Soap Double Bay		
Image Transfer		
Central Medical Gas Pipe Line System		
Refrigerator glass single Door		
Coffee Machine		
CCTV Camera top dome		
Washing Machines		
CCTV Camera		
Stoves		
Over for CCTV Camera		
Sound System for announcements		
Fire extinguishers		
LED TV		
<b>Machinery and Equipment (General)</b>		
Others	Name of Equipment	
	Refrigerator (Domestic) front glass	
	Refrigerator glass single door	
	Air Curtain On Door	
	Washing machines for parties	
	Gas Burner for parties	
	Fire Extinguishers E.C.P.	
	LED TV	
	1 Ton air conditioners (Cabinet)	
	2 Ton air conditioners (Cabinet)	
3 Ton air conditioners (split)		
Ceiling Fans 50"		
Blacket Fans 18"		
Industrial Ceiling		
Refrigerators 18 C.F.T		
Quiet Connector of Electricity		
Express Line etc		
Electricity Distribution Boxes		
Protection cabinet for electricity distribution box		
Bed Sheets and pillow covers		
Pillows		
Blankets with covers		
Shoes for parties		
CCTV Camera		
CCTV Camera top dome		
Fire extinguishers		
DVR		

# MASTER PLAN OF THQ HOSPITAL KAMOKI