

FACILITIES BEING ESTABLISHED

- CT SCAN (Trauma Center)
- UPGRADEATION OF EMERGENCY
- ICU
- CCU
- DIALYSIS
- PHYSIOTHERAPY
- BURN UNIT
- DENTAL UNIT
- LAUNDRY
- MORTUARY
- YELLOW ROOM
- WATER FILTRATION PLANT
- CANTEEN

SERVICES TO BE OUTSOURCE

- MEP
- JANITORIAL
- PARKING & SECURITY
- CAFETERIA
- AC's & GENERATORS
- LAUNDRY
- CT SCAN
- PATHOLOGY LABS
- HORTICULTURE

THEMATIC AREAS OF MSDS

- 2.1 ACCESS, ASSESSMENT, AND C.ONTINUITY OF CARE (AAC)
- CARE OF PATIENTS (COP)
- MANAGEMENT OF MEDICATION (MOM)
- PATIENT RIGHTS AND EDUCATION (PRE)
- HOSPITAL INFECTION CONTROL (HIC)
- CONTINUOUS QUALITY IMPROVEMENT (CQI)
- RESPONSIBILITIES OF MANAGEMENT (ROM)
- FACILITY MANAGEMENT AND SAFETY (FMS)
- HUMAN RESOURCE MANAGEMENT (HRM)
- INFORMATION MANAGEMENT SYSTEM (IMS)

IT INTERVENTIONS

- QUEUE MANAGEMENT SYSTEM
- ELECTRONIC MEDICAL RECORD

NEW MANAGEMENT STRUCTURE

- NMS
- CONSULTANTS
- NURSES
- WMO's
- EMO's
- AHP
- PHARMACISTS
- PHYSIOTHERAPISTS



BY:  
PROJECT MANAGEMENT UNIT  
PRIMARY & SECONDARY  
HEALTHCARE DEPARTMENT  
GOVT. OF PUNJAB

CT. SCAN

EMERGENCY BLOCK

DENTAL UNIT

CCU

BURN UNIT  
ICU

MORTUARY

WATER FILTRATION PLANT  
PRISONERS WARD

PHYSIOTHERAPY  
YELLOW ROOM

LEGEND:  
PROPOSED ELEVATION  
EXISTING BLOCKS  
PROPOSED BLOCKS  
GREEN AREA  
ASPHALT  
PAVERS  
OFFICES/ADMINISTRATION  
RELIGIOUS BUILDING  
HOSTEL  
LAUNDRY  
RESIDENTIAL  
GENERATOR ROOM  
PROPOSED PARKING  
O/H WATER TANK

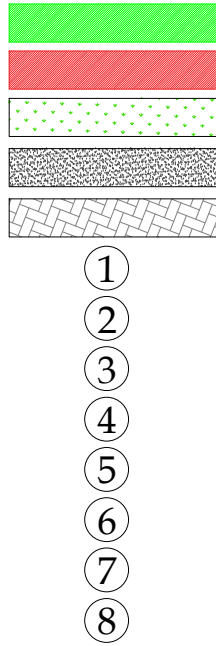

PROPOSED NO. OF CARS = 112  
PROPOSED NO. OF BIKES = 261

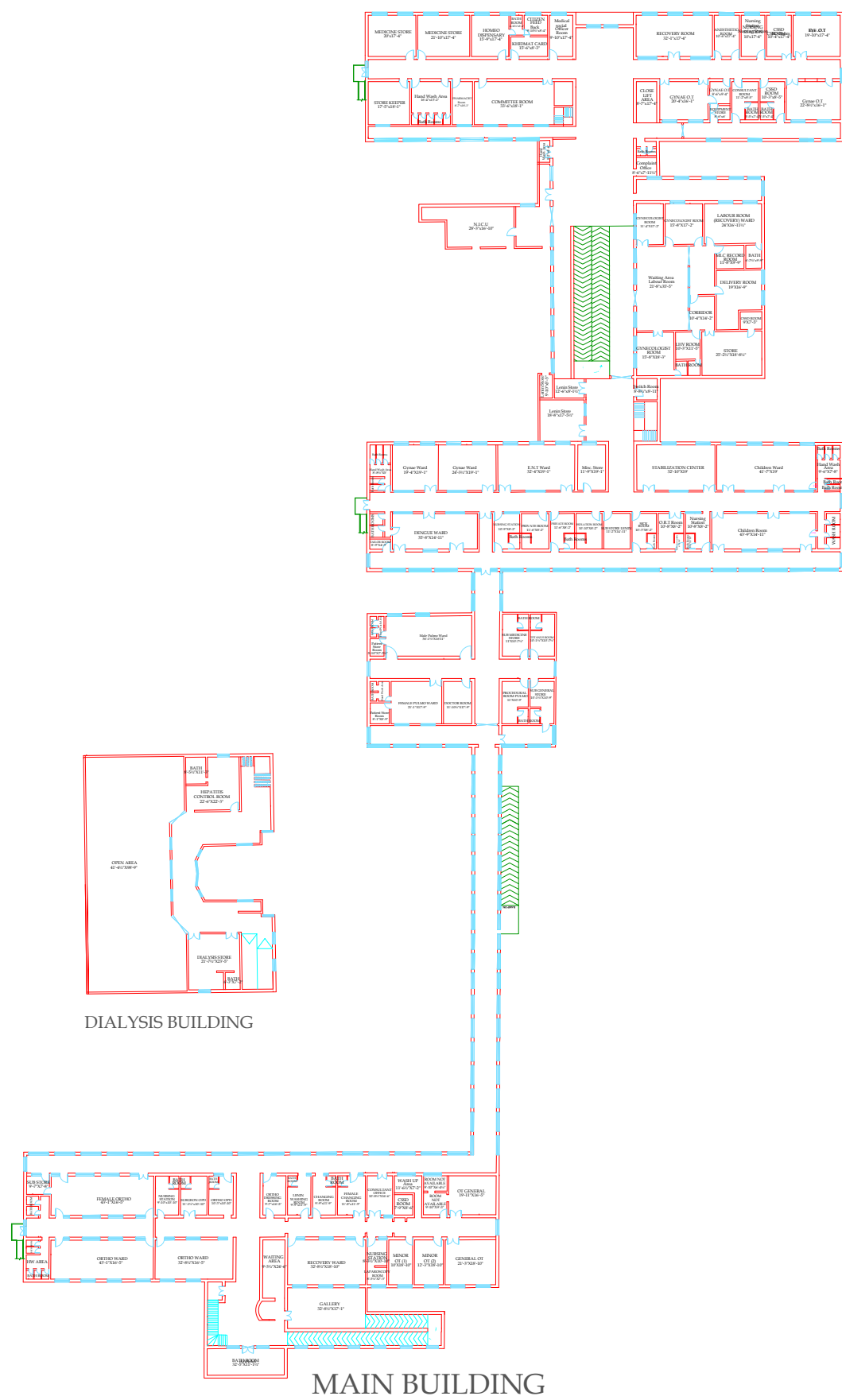

FIRST FLOOR PLAN OF DHQ HOSPITAL BHAKAR

MACHINERY & EQUIPMENTS

Emergency Equipment	
Area	ITEM DESCRIPTION
Reception Area	Table Chairs Computer Data Entry With Printer
Triage area	Table (20 X 40") Chairs (10) B & A apparatus with Apgar (10) Gurney with FOOT STEP (10) Mercury & P apparatus (10) Laryngoscope penile A&B mask (10) Oxygenator (10) ECG Machine with today (10) Central oxygen with accessories F&R wash
Minor O.T	NEBULIZER (10) SUCKER MACHINE (10) CRASH TROLLEY EQUIP (10) INSTRUMENT CABINET (10) MEDICINE TROLLEY (10) O 2 Table with foot step Center Oxygen supply Sucker machine Portable O 2 Lights Ceiling O 2 light No air oven Autoclave Instrument trolley (10) Instrument cabinet GURNEY (10) Sucker machine (10) Nebulizer HD (10) Center Oxygen supply (10) Resuscitation Trolley (fully equipped) (10) Defibrillator (10) Pulse monitor (10) Bedside monitor (10) ECG MACHINE (10) BP APPARATUS (10) ECG STEP (10) ATTENDANT RESCH (10) (MOTORIZED BEDS) with accessories (with foot step) (10) ECG machine with today (10) Pulse monitor (10) Bedside monitor (10) B & A apparatus with Apgar (10) Nebulizer HD (10) Sucker machine (10) Wheel chair (10) Stretcher (10) ambulance pads with Mask (10) ambulance A&B with Mask (10) ambulance A&B (10) Portable x-rays (300 M.A) Portable ultra sound Shoe Cover Machine Vain Finder Acoustic Display Board
Emergency ward	
Generalized	
Others	
Medical Equipment	
Area	Name of Equipment
Laboratory	Semi Auto Clinical Chemistry Analyzer Hematology Analyzer Electrolyte Analyzer Blood Gas Analyzer Water Microscope Water Bath Hot air Oven Chemical water plant Auto pipettes glass vials Centrifuge Machine Static X-ray Machine Mobile X-Ray Machine Computerized Radiography System Chest X-Ray Lead apron and FPE Dental radiolac personal (Add) Lead glass shield Lead Vials
X-Rays	Portable Mobile Ultrasound Color Doppler RADIOLOGY Cardiac Monitor Temporary pace maker Defibrillator ECG Machine Three Channel ETT Machine Color Doppler RADIOLOGY Suction Pump Blood Culture Centrifuge Machine Slide viewer Clinical Microscope Computerized Nemo Dialysis Machine
Ultrasound	
CCU	Baby Cot Phototherapy Unit Infant Warmer Pulse Oximeter Infant Incubator Hospital Grade Nebulizer Heavy Duty
Blood Bank	Anesthesia Machine with Ventilator BED SIDE PATIENT MONITOR ECG Monitor Defibrillator Electrocardiogram Unit Operation Table Ceiling Operating Light STEAM STERILIZER Resuscitation trolley With Crash Cart mayo table MOBILE OPERATING LIGHT Operation Table ORTHOPEDIC DRILL Plaster Ceiling Pneumatic Pneumatic Torquents Orthopedic Instruments Portable Mobile Ultrasound Autoclave Delivery Set Delivery Table ECG Monitor D & C Set Vacuum Extractor CTG Machine ECG Machine Three Channel Delivery table Light Baby Cot Delivery trolley Desktop Fetal Heart Rate Detector Steam Sterilizer Operation Table MOBILE OPERATING LIGHT Suction Pump Laryngoscope Set of Surgical Instruments Stretcher Infant chair foot support Resuscitation trolley With Crash Cart Resuscitation trolley With Crash Cart BP Apparatus Ventilator CPAP X-RAY PROCESSOR Blast wall Switch 12x18x10 Image Intensifier Central Medical Gase Pipe Line System Refrigerator glass single Door Distillery Machine CCTV Camera top dome Washing Machines CCTV Camera Stoves DVR for CCTV Camers Sound System for announcements Fire extinguishers LED TVs
Dialysis Unit (10 beds)	
Nursery	
O.T (04)	
Orthopedic	
Others	
Machinery and Equipment (General)	
Area	Name of Equipment
Others	Refrigerator (Domestic) front glass double door Refrigerator glass single door Air Curtain On Door Washing machines for parties Gas burner for parties Fire extinguishers (CO2) LED TV 4 Ton air conditioners (Cabinet) 2 Ton air conditioners (Cabinet) 2 Ton air conditioners (split) Ceiling Fans 50" Brocket Fans 16" Industrial Exhaust Refrigerators 10 CFT C-wire Connection of Electricity / Express Line etc. Electrical Distribution Boxes Protection cabin for electricity distribution boxes Bed Sheets and pillow covers Blankets Blankets with covers Sieves for parties CCTV Camera CCTV Camera top dome Fire extinguishers DVR