

### FACILITIES BEING ESTABLISHED

- CT SCAN (Trauma Center)
- UPGRADATION OF EMERGENCY
- ICU
- CCU
- DIALYSIS
- PHYSIOTHERAPY
- BURN UNIT
- DENTAL UNIT
- LAUNDRY
- MORTUARY
- YELLOW ROOM
- WATER FILTRATION PLANT
- CANTEN

### SERVICES TO BE OUTSOURCE

- MEP
- JANITORIAL
- PARKING & SECURITY
- CAFETERIA
- AC's & GENERATORS
- LAUNDRY
- CT SCAN
- PATHOLOGY LABS
- HORTICULTURE

### THEMATIC AREAS OF MSDS

- 2.1 ACCESS, ASSESSMENT, AND C.O.N.T.I.N.U.I.T.Y OF CARE (AAC)
- CARE OF PATIENTS (COP)
- MANAGEMENT OF MEDICATION (MOM)
- PATIENT RIGHTS AND EDUCATION (PRE)
- HOSPITAL INFECTION CONTROL (HIC)
- CONTINUOUS QUALITY IMPROVEMENT (CQI)
- RESPONSIBILITIES OF MANGEMENT (ROM)
- FACILITY MANAGEMENT AND SAFETY (FMS)
- HUMAN RESOURCE MANGEMENT (HRM)
- INFORMATION MANGEMENT SYSTEM (IMS)

### IT INTERVENTIONS

- QUEUE MANAGEMENT SYSTEM
- ELECTRONIC MEDICAL RECORD

### NEW MANAGEMENT STRUCTURE

- NMS
- CONSULTANTS
- NURSES
- WMO's
- EMO's
- AHP
- PHARMACISTS
- PHYSIOTHERAPISTS



BY:  
PROJECT MANAGEMENT UNIT  
PRIMARY & SECONDARY  
HEALTHCARE DEPARTMENT  
GOVT. OF PUNJAB

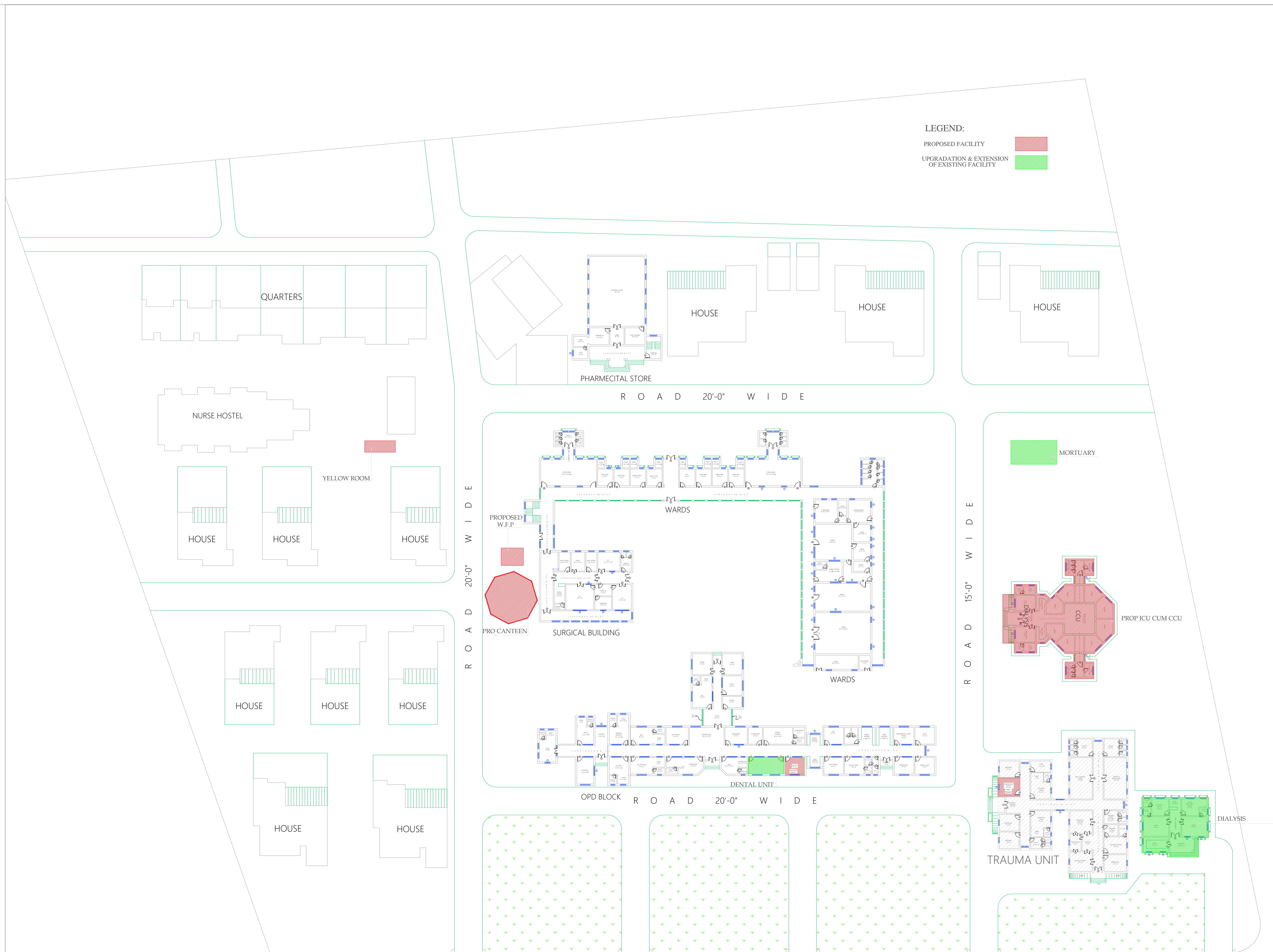

**LEGEND:**  
PROPOSED FACILITY (Red box)  
UPGRADATION & EXTENSION OF EXISTING FACILITY (Green box)

### MACHINERY & EQUIPMENTS

| Emergency Equipment               |   |
|-----------------------------------|---|
| Area                              | Name of Equipment   |
| Reception Area                    | Chair<br>Computer Case Entry With Printer<br>Chair - 10<br>Chair - 10<br>Diagnosis set (N)<br>E.C.G Machine with today (N)<br>Central Oxygen with accessories<br>FOR each<br>NEBULIZER (N)<br>SUCTION MACHINE (N)<br>CRASH TROLLY EQUIPPED (N)<br>RESTRAINT CABINET (N)<br>MEDICINE TROLLY (N)  |
| Triage area                       | O.T table WITH hot mop<br>Center Oxygen supply<br>Suction machine<br>Portable O.L Lights<br>Gelling o.t light<br>Hot air oven<br>Autoclave<br>Instrument trolley (N)<br>Resturant cabinet<br>SUNBURN TSN<br>Suction machine (N)<br>Refrigerator 187 (N)<br>Center Oxygen supply (N)<br>Resuscitation trolley Italy<br>equipped (N)<br>Defibrillator (N)<br>Pulse oximeter (N)<br>Respirator monitor (N)<br>E.C.G MACHINE (N)<br>BP APPARATUS (N)<br>FOOT STEPS (N)<br>ATTENDANT BENCH (N)<br>WOUND DRESSING with<br>accessories (with hot steam) (N)<br>E.C.G machine (Italy) (N)<br>Pulse oximeter (N)<br>Respirator monitor (N)<br>B.P apparatus wall type (N)<br>Nebulizer 187 (N)<br>Suction machine (N)<br>Wound dress (N)<br>Stereocopy (N)<br>Infusion pumps with Mass (N)<br>amino beta beta with Mass (N)<br>Infusion pump (N)<br>Portable X-ray (200 M.A.)<br>Proctore ultra sound<br>Shoe Cover Machine<br>Yan Flyer<br>Azoxi Display Board  |
| Minor O.T                         | Hot air oven<br>Autoclave<br>Instrument trolley (N)<br>Resturant cabinet<br>SUNBURN TSN<br>Suction machine (N)<br>Refrigerator 187 (N)<br>Center Oxygen supply (N)<br>Resuscitation trolley Italy<br>equipped (N)<br>Defibrillator (N)<br>Pulse oximeter (N)<br>Respirator monitor (N)<br>E.C.G MACHINE (N)<br>BP APPARATUS (N)<br>FOOT STEPS (N)<br>ATTENDANT BENCH (N)<br>WOUND DRESSING with<br>accessories (with hot steam) (N)<br>E.C.G machine (Italy) (N)<br>Pulse oximeter (N)<br>Respirator monitor (N)<br>B.P apparatus wall type (N)<br>Nebulizer 187 (N)<br>Suction machine (N)<br>Wound dress (N)<br>Stereocopy (N)<br>Infusion pumps with Mass (N)<br>amino beta beta with Mass (N)<br>Infusion pump (N)<br>Portable X-ray (200 M.A.)<br>Proctore ultra sound<br>Shoe Cover Machine<br>Yan Flyer<br>Azoxi Display Board   |
| Constant & specialized care room  | Hot air oven<br>Autoclave<br>Instrument trolley (N)<br>Resturant cabinet<br>SUNBURN TSN<br>Suction machine (N)<br>Refrigerator 187 (N)<br>Center Oxygen supply (N)<br>Resuscitation trolley Italy<br>equipped (N)<br>Defibrillator (N)<br>Pulse oximeter (N)<br>Respirator monitor (N)<br>E.C.G MACHINE (N)<br>BP APPARATUS (N)<br>FOOT STEPS (N)<br>ATTENDANT BENCH (N)<br>WOUND DRESSING with<br>accessories (with hot steam) (N)<br>E.C.G machine (Italy) (N)<br>Pulse oximeter (N)<br>Respirator monitor (N)<br>B.P apparatus wall type (N)<br>Nebulizer 187 (N)<br>Suction machine (N)<br>Wound dress (N)<br>Stereocopy (N)<br>Infusion pumps with Mass (N)<br>amino beta beta with Mass (N)<br>Infusion pump (N)<br>Portable X-ray (200 M.A.)<br>Proctore ultra sound<br>Shoe Cover Machine<br>Yan Flyer<br>Azoxi Display Board   |
| Emergency ward                    | Hot air oven<br>Autoclave<br>Instrument trolley (N)<br>Resturant cabinet<br>SUNBURN TSN<br>Suction machine (N)<br>Refrigerator 187 (N)<br>Center Oxygen supply (N)<br>Resuscitation trolley Italy<br>equipped (N)<br>Defibrillator (N)<br>Pulse oximeter (N)<br>Respirator monitor (N)<br>E.C.G MACHINE (N)<br>BP APPARATUS (N)<br>FOOT STEPS (N)<br>ATTENDANT BENCH (N)<br>WOUND DRESSING with<br>accessories (with hot steam) (N)<br>E.C.G machine (Italy) (N)<br>Pulse oximeter (N)<br>Respirator monitor (N)<br>B.P apparatus wall type (N)<br>Nebulizer 187 (N)<br>Suction machine (N)<br>Wound dress (N)<br>Stereocopy (N)<br>Infusion pumps with Mass (N)<br>amino beta beta with Mass (N)<br>Infusion pump (N)<br>Portable X-ray (200 M.A.)<br>Proctore ultra sound<br>Shoe Cover Machine<br>Yan Flyer<br>Azoxi Display Board   |
| Generalized                       | Hot air oven<br>Autoclave<br>Instrument trolley (N)<br>Resturant cabinet<br>SUNBURN TSN<br>Suction machine (N)<br>Refrigerator 187 (N)<br>Center Oxygen supply (N)<br>Resuscitation trolley Italy<br>equipped (N)<br>Defibrillator (N)<br>Pulse oximeter (N)<br>Respirator monitor (N)<br>E.C.G MACHINE (N)<br>BP APPARATUS (N)<br>FOOT STEPS (N)<br>ATTENDANT BENCH (N)<br>WOUND DRESSING with<br>accessories (with hot steam) (N)<br>E.C.G machine (Italy) (N)<br>Pulse oximeter (N)<br>Respirator monitor (N)<br>B.P apparatus wall type (N)<br>Nebulizer 187 (N)<br>Suction machine (N)<br>Wound dress (N)<br>Stereocopy (N)<br>Infusion pumps with Mass (N)<br>amino beta beta with Mass (N)<br>Infusion pump (N)<br>Portable X-ray (200 M.A.)<br>Proctore ultra sound<br>Shoe Cover Machine<br>Yan Flyer<br>Azoxi Display Board   |
| Others                            | Hot air oven<br>Autoclave<br>Instrument trolley (N)<br>Resturant cabinet<br>SUNBURN TSN<br>Suction machine (N)<br>Refrigerator 187 (N)<br>Center Oxygen supply (N)<br>Resuscitation trolley Italy<br>equipped (N)<br>Defibrillator (N)<br>Pulse oximeter (N)<br>Respirator monitor (N)<br>E.C.G MACHINE (N)<br>BP APPARATUS (N)<br>FOOT STEPS (N)<br>ATTENDANT BENCH (N)<br>WOUND DRESSING with<br>accessories (with hot steam) (N)<br>E.C.G machine (Italy) (N)<br>Pulse oximeter (N)<br>Respirator monitor (N)<br>B.P apparatus wall type (N)<br>Nebulizer 187 (N)<br>Suction machine (N)<br>Wound dress (N)<br>Stereocopy (N)<br>Infusion pumps with Mass (N)<br>amino beta beta with Mass (N)<br>Infusion pump (N)<br>Portable X-ray (200 M.A.)<br>Proctore ultra sound<br>Shoe Cover Machine<br>Yan Flyer<br>Azoxi Display Board   |
| Medical Equipment                 |   |
| Area                              | Name of Equipment   |
| Laboratory                        | Semi Auto Clinical Chemistry Analyser<br>Hematology Analyser<br>Electrolyte Analyser<br>Blood Gas Analyser<br>Clinical Microscope<br>Water Bath<br>Hot air Oven<br>Distilled water plant<br>Auto pipettes<br>glass wares<br>Centrifuge Machine<br>Stere X-ray Machine<br>Mobile X-ray Machine<br>Computerized Radiography System<br>Diaper 2.5kg<br>Lead apron and PPE<br>Dermatome personal (A&S)<br>Lead glass shield<br>Lead Wall<br>Portable Ultrasound<br>Color Doppler RADIOLOGY<br>Cardiac Monitor<br>Temporary pace maker<br>Defibrillator<br>E.C.G Machine Three Channel<br>ETT Machine<br>Color Doppler CARDIOLOGY<br>Suction Pump<br>Blood Cabinet<br>Formalin Machine<br>Slide viewer<br>Clinical Microscope<br>Computerized Hemo Dialysis (10 beds)<br>Baby Cot<br>Phototherapy Unit<br>Heat Meter<br>Pulse Oximeter<br>Heart Monitor<br>Hospital Grade Nebulizer Heavy Duty<br>Anesthesia Machine with Ventilator<br>BED SIDE PATIENT MONITOR<br>ECU Monitor<br>Defibrillator<br>Electrocardiogram Unit<br>Operation Table<br>Central Operating Light<br>S.T.M. 11111111<br>Resuscitation trolley With Crash Cart<br>crash table<br>MOBILE OPEATING LIGHT<br>Operation Table<br>ORTHOPEDIC DRILL<br>Pneumatic<br>Pneumatic Torque<br>Orthopedic Instruments<br>Portable Ultrasound<br>Autoclave<br>Delivery Set<br>Delivery Table<br>ECU Monitor<br>D.I.C. Set<br>Vacuum Extractor<br>E.C.G Machine<br>E.C.G Machine Three Channel<br>Infusion pump<br>Baby Cot<br>Distilled Water<br>Desator Fetal Heart Rate Detector |
| X-Rays                            | Stere X-ray Machine<br>Mobile X-ray Machine<br>Computerized Radiography System<br>Diaper 2.5kg<br>Lead apron and PPE<br>Dermatome personal (A&S)<br>Lead glass shield<br>Lead Wall<br>Portable Ultrasound<br>Color Doppler RADIOLOGY<br>Cardiac Monitor<br>Temporary pace maker<br>Defibrillator<br>E.C.G Machine Three Channel<br>ETT Machine<br>Color Doppler CARDIOLOGY<br>Suction Pump<br>Blood Cabinet<br>Formalin Machine<br>Slide viewer<br>Clinical Microscope<br>Computerized Hemo Dialysis (10 beds)<br>Baby Cot<br>Phototherapy Unit<br>Heat Meter<br>Pulse Oximeter<br>Heart Monitor<br>Hospital Grade Nebulizer Heavy Duty<br>Anesthesia Machine with Ventilator<br>BED SIDE PATIENT MONITOR<br>ECU Monitor<br>Defibrillator<br>Electrocardiogram Unit<br>Operation Table<br>Central Operating Light<br>S.T.M. 11111111<br>Resuscitation trolley With Crash Cart<br>crash table<br>MOBILE OPEATING LIGHT<br>Operation Table<br>ORTHOPEDIC DRILL<br>Pneumatic<br>Pneumatic Torque<br>Orthopedic Instruments<br>Portable Ultrasound<br>Autoclave<br>Delivery Set<br>Delivery Table<br>ECU Monitor<br>D.I.C. Set<br>Vacuum Extractor<br>E.C.G Machine<br>E.C.G Machine Three Channel<br>Infusion pump<br>Baby Cot<br>Distilled Water<br>Desator Fetal Heart Rate Detector   |
| Ultrasound                        | Stere X-ray Machine<br>Mobile X-ray Machine<br>Computerized Radiography System<br>Diaper 2.5kg<br>Lead apron and PPE<br>Dermatome personal (A&S)<br>Lead glass shield<br>Lead Wall<br>Portable Ultrasound<br>Color Doppler RADIOLOGY<br>Cardiac Monitor<br>Temporary pace maker<br>Defibrillator<br>E.C.G Machine Three Channel<br>ETT Machine<br>Color Doppler CARDIOLOGY<br>Suction Pump<br>Blood Cabinet<br>Formalin Machine<br>Slide viewer<br>Clinical Microscope<br>Computerized Hemo Dialysis (10 beds)<br>Baby Cot<br>Phototherapy Unit<br>Heat Meter<br>Pulse Oximeter<br>Heart Monitor<br>Hospital Grade Nebulizer Heavy Duty<br>Anesthesia Machine with Ventilator<br>BED SIDE PATIENT MONITOR<br>ECU Monitor<br>Defibrillator<br>Electrocardiogram Unit<br>Operation Table<br>Central Operating Light<br>S.T.M. 11111111<br>Resuscitation trolley With Crash Cart<br>crash table<br>MOBILE OPEATING LIGHT<br>Operation Table<br>ORTHOPEDIC DRILL<br>Pneumatic<br>Pneumatic Torque<br>Orthopedic Instruments<br>Portable Ultrasound<br>Autoclave<br>Delivery Set<br>Delivery Table<br>ECU Monitor<br>D.I.C. Set<br>Vacuum Extractor<br>E.C.G Machine<br>E.C.G Machine Three Channel<br>Infusion pump<br>Baby Cot<br>Distilled Water<br>Desator Fetal Heart Rate Detector   |
| CCU                               | Stere X-ray Machine<br>Mobile X-ray Machine<br>Computerized Radiography System<br>Diaper 2.5kg<br>Lead apron and PPE<br>Dermatome personal (A&S)<br>Lead glass shield<br>Lead Wall<br>Portable Ultrasound<br>Color Doppler RADIOLOGY<br>Cardiac Monitor<br>Temporary pace maker<br>Defibrillator<br>E.C.G Machine Three Channel<br>ETT Machine<br>Color Doppler CARDIOLOGY<br>Suction Pump<br>Blood Cabinet<br>Formalin Machine<br>Slide viewer<br>Clinical Microscope<br>Computerized Hemo Dialysis (10 beds)<br>Baby Cot<br>Phototherapy Unit<br>Heat Meter<br>Pulse Oximeter<br>Heart Monitor<br>Hospital Grade Nebulizer Heavy Duty<br>Anesthesia Machine with Ventilator<br>BED SIDE PATIENT MONITOR<br>ECU Monitor<br>Defibrillator<br>Electrocardiogram Unit<br>Operation Table<br>Central Operating Light<br>S.T.M. 11111111<br>Resuscitation trolley With Crash Cart<br>crash table<br>MOBILE OPEATING LIGHT<br>Operation Table<br>ORTHOPEDIC DRILL<br>Pneumatic<br>Pneumatic Torque<br>Orthopedic Instruments<br>Portable Ultrasound<br>Autoclave<br>Delivery Set<br>Delivery Table<br>ECU Monitor<br>D.I.C. Set<br>Vacuum Extractor<br>E.C.G Machine<br>E.C.G Machine Three Channel<br>Infusion pump<br>Baby Cot<br>Distilled Water<br>Desator Fetal Heart Rate Detector   |
| Blood Bank                        | Stere X-ray Machine<br>Mobile X-ray Machine<br>Computerized Radiography System<br>Diaper 2.5kg<br>Lead apron and PPE<br>Dermatome personal (A&S)<br>Lead glass shield<br>Lead Wall<br>Portable Ultrasound<br>Color Doppler RADIOLOGY<br>Cardiac Monitor<br>Temporary pace maker<br>Defibrillator<br>E.C.G Machine Three Channel<br>ETT Machine<br>Color Doppler CARDIOLOGY<br>Suction Pump<br>Blood Cabinet<br>Formalin Machine<br>Slide viewer<br>Clinical Microscope<br>Computerized Hemo Dialysis (10 beds)<br>Baby Cot<br>Phototherapy Unit<br>Heat Meter<br>Pulse Oximeter<br>Heart Monitor<br>Hospital Grade Nebulizer Heavy Duty<br>Anesthesia Machine with Ventilator<br>BED SIDE PATIENT MONITOR<br>ECU Monitor<br>Defibrillator<br>Electrocardiogram Unit<br>Operation Table<br>Central Operating Light<br>S.T.M. 11111111<br>Resuscitation trolley With Crash Cart<br>crash table<br>MOBILE OPEATING LIGHT<br>Operation Table<br>ORTHOPEDIC DRILL<br>Pneumatic<br>Pneumatic Torque<br>Orthopedic Instruments<br>Portable Ultrasound<br>Autoclave<br>Delivery Set<br>Delivery Table<br>ECU Monitor<br>D.I.C. Set<br>Vacuum Extractor<br>E.C.G Machine<br>E.C.G Machine Three Channel<br>Infusion pump<br>Baby Cot<br>Distilled Water<br>Desator Fetal Heart Rate Detector   |
| Dialysis Unit (10 beds)           | Stere X-ray Machine<br>Mobile X-ray Machine<br>Computerized Radiography System<br>Diaper 2.5kg<br>Lead apron and PPE<br>Dermatome personal (A&S)<br>Lead glass shield<br>Lead Wall<br>Portable Ultrasound<br>Color Doppler RADIOLOGY<br>Cardiac Monitor<br>Temporary pace maker<br>Defibrillator<br>E.C.G Machine Three Channel<br>ETT Machine<br>Color Doppler CARDIOLOGY<br>Suction Pump<br>Blood Cabinet<br>Formalin Machine<br>Slide viewer<br>Clinical Microscope<br>Computerized Hemo Dialysis (10 beds)<br>Baby Cot<br>Phototherapy Unit<br>Heat Meter<br>Pulse Oximeter<br>Heart Monitor<br>Hospital Grade Nebulizer Heavy Duty<br>Anesthesia Machine with Ventilator<br>BED SIDE PATIENT MONITOR<br>ECU Monitor<br>Defibrillator<br>Electrocardiogram Unit<br>Operation Table<br>Central Operating Light<br>S.T.M. 11111111<br>Resuscitation trolley With Crash Cart<br>crash table<br>MOBILE OPEATING LIGHT<br>Operation Table<br>ORTHOPEDIC DRILL<br>Pneumatic<br>Pneumatic Torque<br>Orthopedic Instruments<br>Portable Ultrasound<br>Autoclave<br>Delivery Set<br>Delivery Table<br>ECU Monitor<br>D.I.C. Set<br>Vacuum Extractor<br>E.C.G Machine<br>E.C.G Machine Three Channel<br>Infusion pump<br>Baby Cot<br>Distilled Water<br>Desator Fetal Heart Rate Detector   |
| Nursery                           | Stere X-ray Machine<br>Mobile X-ray Machine<br>Computerized Radiography System<br>Diaper 2.5kg<br>Lead apron and PPE<br>Dermatome personal (A&S)<br>Lead glass shield<br>Lead Wall<br>Portable Ultrasound<br>Color Doppler RADIOLOGY<br>Cardiac Monitor<br>Temporary pace maker<br>Defibrillator<br>E.C.G Machine Three Channel<br>ETT Machine<br>Color Doppler CARDIOLOGY<br>Suction Pump<br>Blood Cabinet<br>Formalin Machine<br>Slide viewer<br>Clinical Microscope<br>Computerized Hemo Dialysis (10 beds)<br>Baby Cot<br>Phototherapy Unit<br>Heat Meter<br>Pulse Oximeter<br>Heart Monitor<br>Hospital Grade Nebulizer Heavy Duty<br>Anesthesia Machine with Ventilator<br>BED SIDE PATIENT MONITOR<br>ECU Monitor<br>Defibrillator<br>Electrocardiogram Unit<br>Operation Table<br>Central Operating Light<br>S.T.M. 11111111<br>Resuscitation trolley With Crash Cart<br>crash table<br>MOBILE OPEATING LIGHT<br>Operation Table<br>ORTHOPEDIC DRILL<br>Pneumatic<br>Pneumatic Torque<br>Orthopedic Instruments<br>Portable Ultrasound<br>Autoclave<br>Delivery Set<br>Delivery Table<br>ECU Monitor<br>D.I.C. Set<br>Vacuum Extractor<br>E.C.G Machine<br>E.C.G Machine Three Channel<br>Infusion pump<br>Baby Cot<br>Distilled Water<br>Desator Fetal Heart Rate Detector   |
| O.T (04)                          | Stere X-ray Machine<br>Mobile X-ray Machine<br>Computerized Radiography System<br>Diaper 2.5kg<br>Lead apron and PPE<br>Dermatome personal (A&S)<br>Lead glass shield<br>Lead Wall<br>Portable Ultrasound<br>Color Doppler RADIOLOGY<br>Cardiac Monitor<br>Temporary pace maker<br>Defibrillator<br>E.C.G Machine Three Channel<br>ETT Machine<br>Color Doppler CARDIOLOGY<br>Suction Pump<br>Blood Cabinet<br>Formalin Machine<br>Slide viewer<br>Clinical Microscope<br>Computerized Hemo Dialysis (10 beds)<br>Baby Cot<br>Phototherapy Unit<br>Heat Meter<br>Pulse Oximeter<br>Heart Monitor<br>Hospital Grade Nebulizer Heavy Duty<br>Anesthesia Machine with Ventilator<br>BED SIDE PATIENT MONITOR<br>ECU Monitor<br>Defibrillator<br>Electrocardiogram Unit<br>Operation Table<br>Central Operating Light<br>S.T.M. 11111111<br>Resuscitation trolley With Crash Cart<br>crash table<br>MOBILE OPEATING LIGHT<br>Operation Table<br>ORTHOPEDIC DRILL<br>Pneumatic<br>Pneumatic Torque<br>Orthopedic Instruments<br>Portable Ultrasound<br>Autoclave<br>Delivery Set<br>Delivery Table<br>ECU Monitor<br>D.I.C. Set<br>Vacuum Extractor<br>E.C.G Machine<br>E.C.G Machine Three Channel<br>Infusion pump<br>Baby Cot<br>Distilled Water<br>Desator Fetal Heart Rate Detector   |
| Orthopedic                        | Stere X-ray Machine<br>Mobile X-ray Machine<br>Computerized Radiography System<br>Diaper 2.5kg<br>Lead apron and PPE<br>Dermatome personal (A&S)<br>Lead glass shield<br>Lead Wall<br>Portable Ultrasound<br>Color Doppler RADIOLOGY<br>Cardiac Monitor<br>Temporary pace maker<br>Defibrillator<br>E.C.G Machine Three Channel<br>ETT Machine<br>Color Doppler CARDIOLOGY<br>Suction Pump<br>Blood Cabinet<br>Formalin Machine<br>Slide viewer<br>Clinical Microscope<br>Computerized Hemo Dialysis (10 beds)<br>Baby Cot<br>Phototherapy Unit<br>Heat Meter<br>Pulse Oximeter<br>Heart Monitor<br>Hospital Grade Nebulizer Heavy Duty<br>Anesthesia Machine with Ventilator<br>BED SIDE PATIENT MONITOR<br>ECU Monitor<br>Defibrillator<br>Electrocardiogram Unit<br>Operation Table<br>Central Operating Light<br>S.T.M. 11111111<br>Resuscitation trolley With Crash Cart<br>crash table<br>MOBILE OPEATING LIGHT<br>Operation Table<br>ORTHOPEDIC DRILL<br>Pneumatic<br>Pneumatic Torque<br>Orthopedic Instruments<br>Portable Ultrasound<br>Autoclave<br>Delivery Set<br>Delivery Table<br>ECU Monitor<br>D.I.C. Set<br>Vacuum Extractor<br>E.C.G Machine<br>E.C.G Machine Three Channel<br>Infusion pump<br>Baby Cot<br>Distilled Water<br>Desator Fetal Heart Rate Detector   |
| Opnea (20 beds)                   | Stere X-ray Machine<br>Mobile X-ray Machine<br>Computerized Radiography System<br>Diaper 2.5kg<br>Lead apron and PPE<br>Dermatome personal (A&S)<br>Lead glass shield<br>Lead Wall<br>Portable Ultrasound<br>Color Doppler RADIOLOGY<br>Cardiac Monitor<br>Temporary pace maker<br>Defibrillator<br>E.C.G Machine Three Channel<br>ETT Machine<br>Color Doppler CARDIOLOGY<br>Suction Pump<br>Blood Cabinet<br>Formalin Machine<br>Slide viewer<br>Clinical Microscope<br>Computerized Hemo Dialysis (10 beds)<br>Baby Cot<br>Phototherapy Unit<br>Heat Meter<br>Pulse Oximeter<br>Heart Monitor<br>Hospital Grade Nebulizer Heavy Duty<br>Anesthesia Machine with Ventilator<br>BED SIDE PATIENT MONITOR<br>ECU Monitor<br>Defibrillator<br>Electrocardiogram Unit<br>Operation Table<br>Central Operating Light<br>S.T.M. 11111111<br>Resuscitation trolley With Crash Cart<br>crash table<br>MOBILE OPEATING LIGHT<br>Operation Table<br>ORTHOPEDIC DRILL<br>Pneumatic<br>Pneumatic Torque<br>Orthopedic Instruments<br>Portable Ultrasound<br>Autoclave<br>Delivery Set<br>Delivery Table<br>ECU Monitor<br>D.I.C. Set<br>Vacuum Extractor<br>E.C.G Machine<br>E.C.G Machine Three Channel<br>Infusion pump<br>Baby Cot<br>Distilled Water<br>Desator Fetal Heart Rate Detector   |
| Surgical Emergency (10 beds)      | Stere X-ray Machine<br>Mobile X-ray Machine<br>Computerized Radiography System<br>Diaper 2.5kg<br>Lead apron and PPE<br>Dermatome personal (A&S)<br>Lead glass shield<br>Lead Wall<br>Portable Ultrasound<br>Color Doppler RADIOLOGY<br>Cardiac Monitor<br>Temporary pace maker<br>Defibrillator<br>E.C.G Machine Three Channel<br>ETT Machine<br>Color Doppler CARDIOLOGY<br>Suction Pump<br>Blood Cabinet<br>Formalin Machine<br>Slide viewer<br>Clinical Microscope<br>Computerized Hemo Dialysis (10 beds)<br>Baby Cot<br>Phototherapy Unit<br>Heat Meter<br>Pulse Oximeter<br>Heart Monitor<br>Hospital Grade Nebulizer Heavy Duty<br>Anesthesia Machine with Ventilator<br>BED SIDE PATIENT MONITOR<br>ECU Monitor<br>Defibrillator<br>Electrocardiogram Unit<br>Operation Table<br>Central Operating Light<br>S.T.M. 11111111<br>Resuscitation trolley With Crash Cart<br>crash table<br>MOBILE OPEATING LIGHT<br>Operation Table<br>ORTHOPEDIC DRILL<br>Pneumatic<br>Pneumatic Torque<br>Orthopedic Instruments<br>Portable Ultrasound<br>Autoclave<br>Delivery Set<br>Delivery Table<br>ECU Monitor<br>D.I.C. Set<br>Vacuum Extractor<br>E.C.G Machine<br>E.C.G Machine Three Channel<br>Infusion pump<br>Baby Cot<br>Distilled Water<br>Desator Fetal Heart Rate Detector   |
| Machinery and Equipment (General) |   |
| Area                              | Name of Equipment   |
| Others                            | Refrigerator Domestic Port glass<br>double door<br>Refrigerator glass single door<br>Air Curtan On Door<br>Washing machine for patients<br>Gas Burner for patients<br>Fire Extinguishers (CO2)<br>LIFT TV<br>4 Ton air conditioners (Cabinet)<br>2 Ton air conditioners (Cabinet)<br>Ceiling fans (left)<br>Ceiling fans (right)<br>Washed 1 nos. 10"<br>Industrial Exhaust<br>Refrigerator 10 C.F.T<br>Duct Connection of Electricity/<br>Electricity Line<br>Electricity Distribution Boxes<br>Protection cabin for electricity<br>distribution boxes<br>Bed Sheets and pillow covers<br>Pillows<br>Blankets with covers  |

# MASTER PLAN OF THQ AHMEDPUR EAST